

Current part is item (1) on diagram. Available at www.oshkoshequipment.com

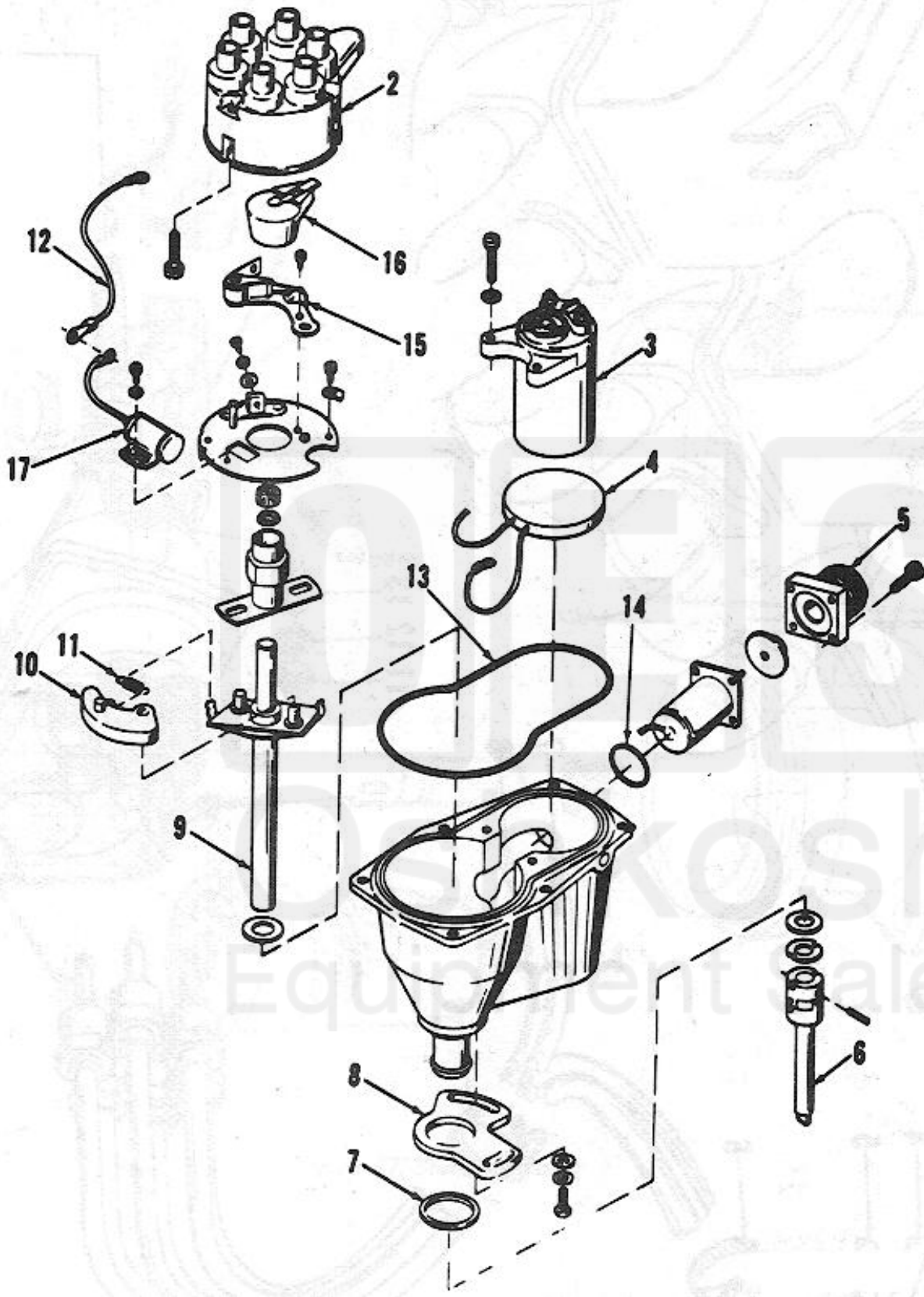

Figure 39: Ignitor Assembly

Page 104

(6)
30-day DS
maint.
allowance

(7)
30-day GS
maint.
allowance

(10)
Illustration

Current part is item (1) on diagram. Available at www.oshkoshequipment.com

Current part is item (1) on diagram. Available at www.oshkoshequipment.com

(1) SMR code	(2) Federal Stock Number	(3) Description Reference Number & Mfg. Code Usable on Code	(4) Unit of meas	(5) Qty inc in unit	(6)			(7)			(8) 1-yr alw per 100 equip cntgcy	(9) Depot maint alw per 100 equip	(a) Figure No.	(b) Item No.
					(a)	(b)	(c)	(a)	(b)	(c)				
		0605- IGNITION COMPONENTS -Continued												
		IGNITOR ASSEMBLY Continued												
PO	2920-933-3577	COVER, DISTRIBUTOR CAP 7374883 (19207)	EA	1	*	*	*	*	*	*			39	1
PO	2920-737-4880	CAP ASSEMBLY, DISTRIBUTOR 7374880 (19207)	EA	1	*	*	*	*	*	*			39	2
PO	2920-933-3728	COIL, IGNITION 8712400 (19207)	EA	1	*	*	*	*	*	*			39	3
PO	2920-928-6138	BALLAST, IGNITOR 8712401 (19207)	EA	1	*	*	*	*	*	*			39	4
X20		RECEPTACLE IGNITOR IBF9 (19728)	EA	1	*	*	*	*	*	*			39	5
PF	2920-928-6137	SHAFT, EXTENSION IAT2105S (19728)	EA	1	*	*	*	*	*	*			39	6
PF		GASKET, ADVANCE ARM IAU15A (19728)	EA	1	*	*	*	*	*	*			39	7
X2F		ARM, ADVANCE IAU 103 (19728)	EA	1	*	*	*	*	*	*			39	8
PF	2920-928-6139	DRIVE SHAFT, IGNITOR IAT1117(19728)	EA	1	*	*	*	*	*	*			39	9
X2F		WEIGHT SET, IGNITOR IGC2168LS (19728)	EA	1	*	*	*	*	*	*			39	10
X2F		SPRING SET, IGNITOR WEIGHT 1GS228S (19728)	EA	1	*	*	*	*	*	*			39	11
PO	2420-279-7377	LEAD, PRIMARY 118730 (24617)	EA	1	*	*	*	*	*	*			39	12
PO	2920-933-3591	REPAIR KIT, IGNITOR 5704414 (19207)	EA	1	*	*	*	*	*	*				
		COMPOSED OF:												
X1		1-PACKING, PREFORMED COVER 11640748(19207)											39	13

(1) SMR code	(2) Federal Stock Number	(3) Description Reference Number & Mfg. Code Usable on Code	(4) Unit of meas	(5) Qty inc in unit	(6) 30-day DS maint. allowance			(7) 30-day GS maint. allowance			(8) 1-yr alw per 100 equip cntgcy	(9) Depot maint alw per 100 equip	(10) Illustration	
					(a)	(b)	(c)	(a)	(b)	(c)			(a)	(b)
		0605-IGNITION COMPONENTS-Continued												
		REPAIR KIT, IGNITOR-Continued												
X1		1-PACKING, PREFORMED, RECEPTACLE XA744AA (19728)			*	*	*	*	*	*			39	14

Current part is item (1) on diagram. Available at www.oshkoshequipment.com